

© 2013 Nokia © 2014 Microsoft

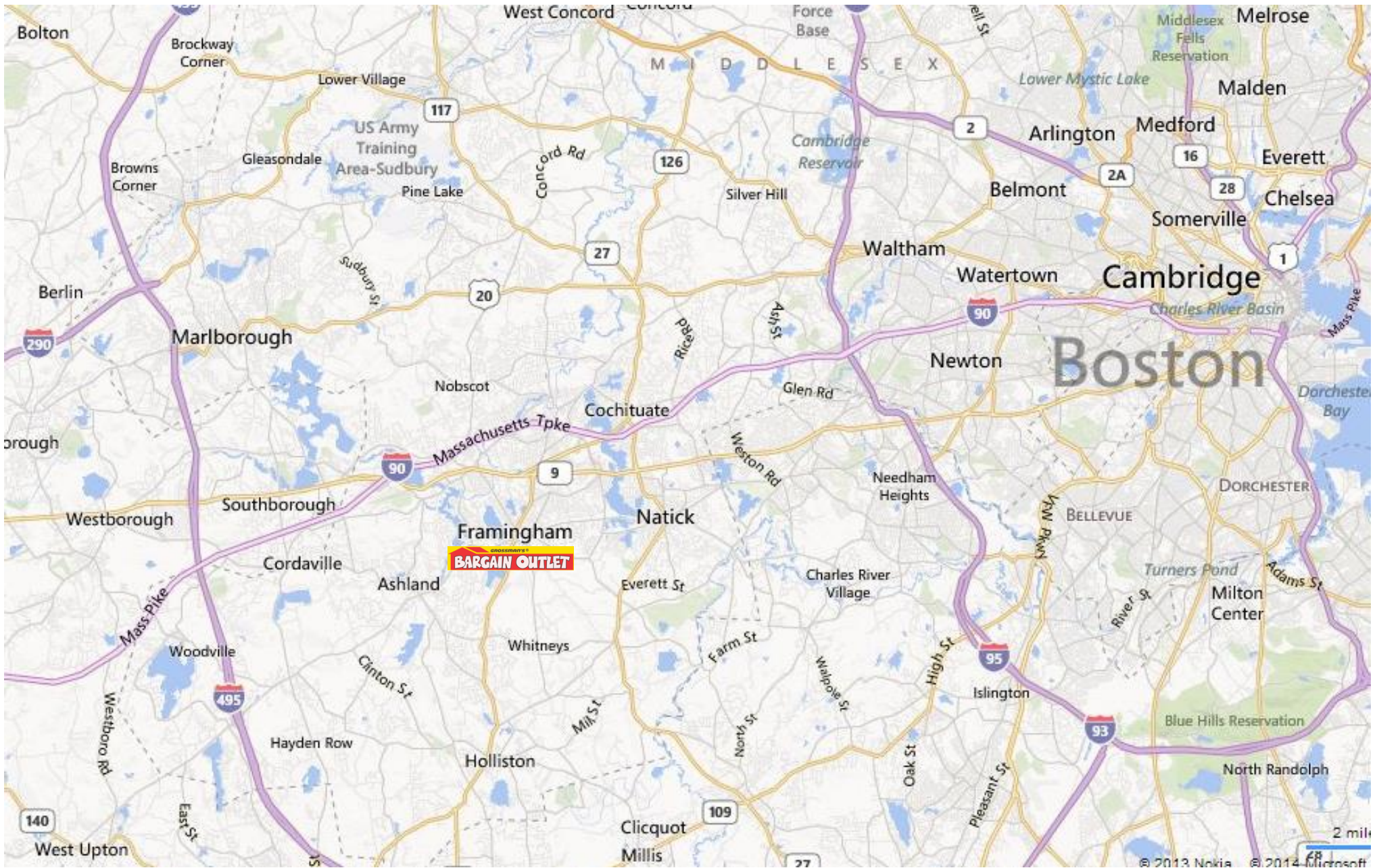

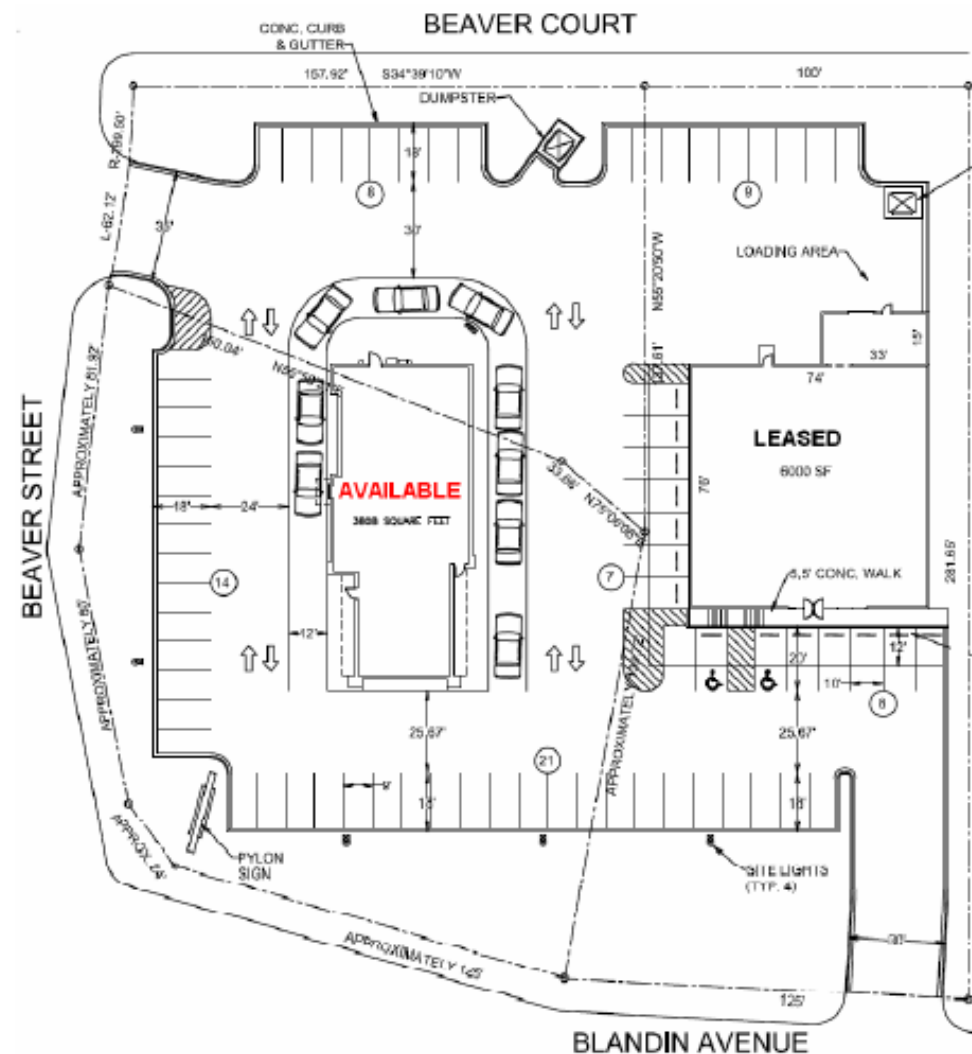

Framingham, MA 01702	3 ml radius		5 ml radius		10 ml radius	
Population						
Estimated Population (2013)	72,233		134,158		366,785	
Projected Population (2018)	74,144		137,778		377,013	
Census Population (2010)	71,666		133,090		363,758	
Census Population (2000)	69,538		129,076		351,106	
<i>Projected Annual Growth (2013 to 2018)</i>	1,912	0.5%	3,620	0.5%	10,228	0.6%
<i>Historical Annual Growth (2010 to 2013)</i>	567	0.3%	1,068	0.3%	3,027	0.3%
<i>Historical Annual Growth (2000 to 2010)</i>	2,128	0.3%	4,014	0.3%	12,653	0.4%
Households						
Estimated Households (2013)	28,360		52,196		135,527	
Projected Households (2018)	29,269		53,873		140,094	
Census Households (2010)	27,909		51,365		133,261	
Census Households (2000)	27,769		50,176		128,690	
<i>Projected Annual Growth (2013 to 2018)</i>	909	0.6%	1,677	0.6%	4,568	0.7%
<i>Historical Annual Growth (2010 to 2013)</i>	451	0.5%	831	0.5%	2,265	0.6%
<i>Historical Annual Growth (2000 to 2010)</i>	140	0.1%	1,189	0.2%	4,571	0.4%
Average Household Income						
Estimated Average Household Income (2013)	\$87,665		\$105,340		\$143,827	
Projected Average Household Income (2018)	\$92,525		\$112,195		\$158,562	
Census Average Household Income (2010)	\$82,779		\$99,034		\$131,297	
Census Average Household Income (2000)	\$65,983		\$80,599		\$105,634	
<i>Projected Annual Growth (2013 to 2018)</i>	\$4,860	1.1%	\$6,855	1.3%	\$14,735	2.0%
<i>Historical Annual Growth (2010 to 2013)</i>	\$4,886	2.0%	\$6,305	2.1%	\$12,530	3.2%
<i>Historical Annual Growth (2000 to 2010)</i>	\$16,796	2.5%	\$18,435	2.3%	\$25,664	2.4%
Median Household Income						
Estimated Median Household Income (2013)	\$77,022		\$89,873		\$111,820	
Projected Median Household Income (2018)	\$85,005		\$100,049		\$127,781	
Census Median Household Income (2010)	\$71,299		\$82,286		\$99,556	
Census Median Household Income (2000)	\$56,033		\$67,006		\$82,970	
<i>Projected Annual Growth (2013 to 2018)</i>	\$7,984	2.1%	\$10,176	2.3%	\$15,961	2.9%
<i>Historical Annual Growth (2010 to 2013)</i>	\$5,723	2.7%	\$7,587	3.1%	\$12,264	4.1%
<i>Historical Annual Growth (2000 to 2010)</i>	\$15,266	2.7%	\$15,280	2.3%	\$16,586	2.0%

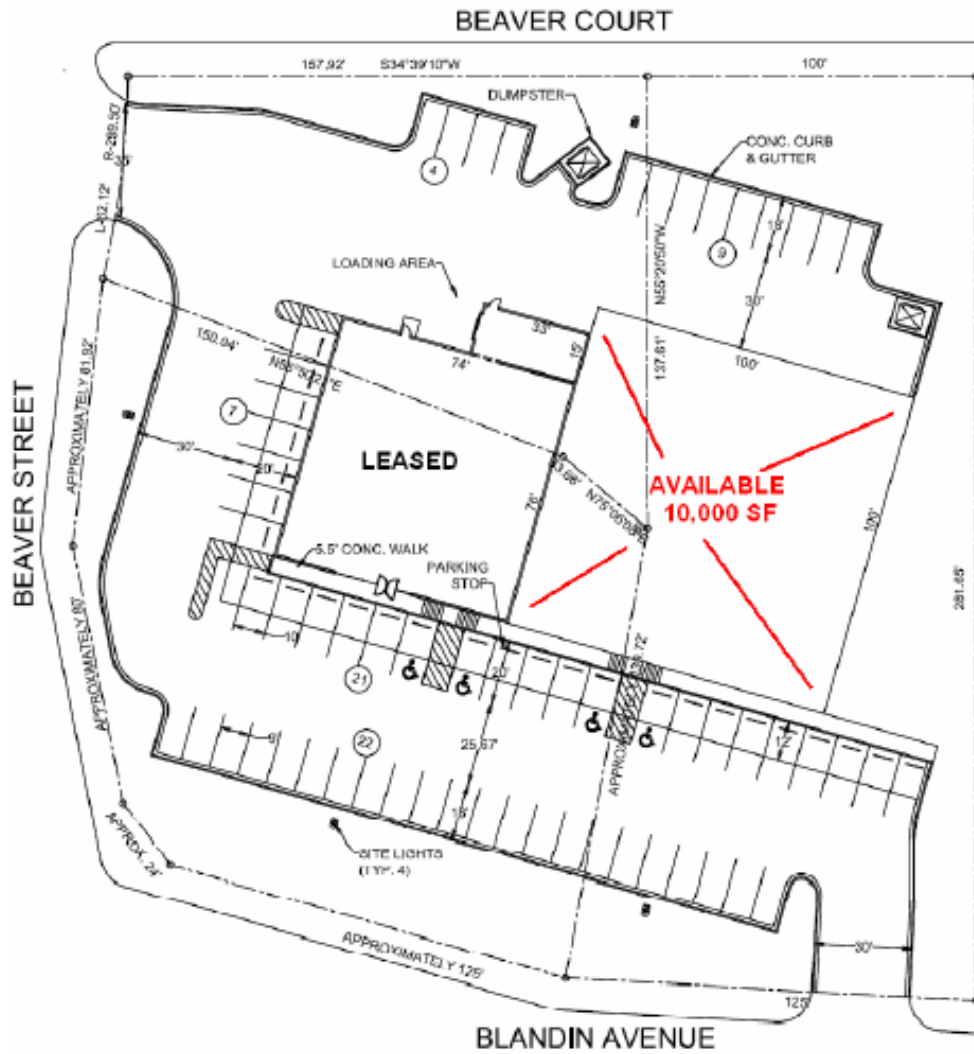

DEMOGRAPHICS: 24 Blandin Ave

	1 Mile	2 Mile	3 Mile
Population	20,941	42,569	68,016
Average HH Income	\$48,488	\$59,984	\$70,117
Employment	13,441	28,732	54,526

TRAFFIC: Total intersection 25 – 30,000 ADT est